

		Boccole		Socket					
Zinc. elettr.	Filetto	Carico		L	D	l ₁	l ₂	d	Peso
Electr.Galv.	Threaded	Load Group		mm	mm	mm	mm	mm	Weight
	Rd	f _{cu} >15N/mm ² t							Kg/pz
BT1240-CE	12	0,5		40	17	12	18	8	0,041
BT1447-CE	14								
BT1654-CE	16	1,2		58	22	15	28,5	13	0,092
BT1865-CE	18								
BT2069-CE	20	2,0		69	27	19	32,5	15	0,161
BT2478-CE	24	2,5		78	32	23	34	18	0,249
BT30103-CE	30	4,0		101	41	28	48	22	0,550
BT36125-CE	36	6,3		125	49	35	60,5	27	0,955
	42	10,0		145	54	40	71	32	1,202
	52	12,5		195	67	50	100	40	2,464

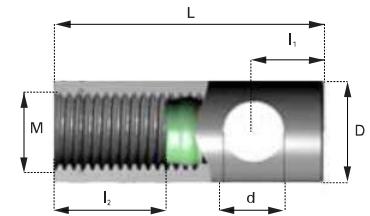

		Boccola ad onda		Wave socket					
Zinc. elettr.	Filetto	Carico		d	L	D	l ₁	l ₂	Peso
Electr.Galv.	Threaded	Load Group		mm	mm	mm	mm	mm	Weight
	Rd	f _{cu} >15N/mm ² t							Kg/pz
TGK-M12-108	12	0,5		8	108	17	45	18	0,084
TGK-M16-167	16	1,2		12	167	22	58	25	0,230
TGK-M20-187	20	2,0		14	187	27	76	34	0,373
TGK-M24-240	24	2,5		16	240	32	87	40	0,618
TGK-M24-360	24	2,5		16	360	32	87	40	0,809
TGK-M30-300	30	4,0		20	300	39	101	52	1,112
TGK-M30-240	30	4,0		20	420	39	101	52	1,401
TGK-M36-380	36	6,3		25	380	48	119	56	2,161
TGK-M42-450	42	8,0		28	450	54	153	65	3,327
TGK-M42-500	42	8,0		28	500	54	153	65	3,569

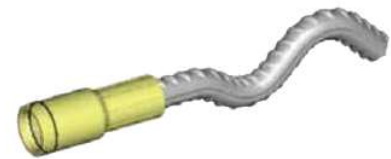
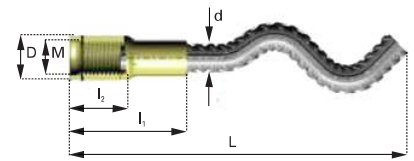

		Boccola ad onda lunga		Long wave socket					
Zinc. elettr.	Filetto	Carico		d	L	D	l ₁	l ₂	Peso
Electr.Galv.	Threaded	Load Group		mm	mm	mm	mm	mm	Weight
	Rd	f _{cu} >15N/mm ² t							Kg/pz
TGL-M12-137	12	0,5		8	137	17	45	18	0,095
TGL-M16-216	16	1,2		12	216	22	58	25	0,276
TGL-M20-257	20	2,0		14	257	27	76	34	0,458
TGL-M24-360	24	2,5		16	360	32	87	40	0,809
TGL-M24-1000	24	2,5		16	1000	32	87	40	1,826
TGL-M30-450	30	4,0		20	450	39	101	52	1,483
TGL-M36-570	36	6,3		25	570	48	119	56	2,893
TGL-M42-620	42	8,0		28	620	54	153	65	4,150

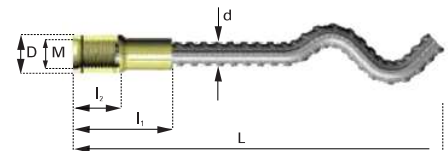

Tutti i tipi di boccole sono disponibili a richiesta con passo metrico M

All the sockets are available upon request with metric pacing

Boccola dritta		Straight socket							
Zincata elettrol.	Filetto	Carico	d	L	D	l ₁	l ₂	Peso	
Electrolytic Galv.	Threaded	Load Group	mm	mm	mm	mm	mm	Weight	
	Rd	f _{cu} >15N/mm ² t	mm	mm	mm	mm	mm	Kg/pz	
TRL-MRd12-116	12	0,5	8	116	17	45	18	0,084	
TRL-MRd12-144	12	0,5	8	144	17	45	18	0,095	
TRL-MRd16-178	16	1,2	12	178	22	58	25	0,230	
TRL-MRd16-230	16	1,2	12	230	22	58	25	0,276	
TRL-MRd20-170	20	2,0	14	170	27	76	34	0,337	
TRL-MRd20-200	20	2,0	14	200	27	76	34	0,373	
TRL-MRd20-270	20	2,0	14	270	27	76	34	0,458	
TRL-MRd24-257	24	2,5	16	257	32	87	40	0,618	
TRL-MRd24-376	24	2,5	16	376	32	87	40	0,809	
TRL-MRd24-1012	24	2,5	16	1012	32	87	40	1,826	
TRL-MRd30-319	30	4,0	20	319	39	101	52	1,112	
TRL-MRd30-436	30	4,0	20	436	39	101	52	1,401	
TRL-MRd30-469	30	4,0	20	469	39	101	52	1,483	
TRL-MRd36-402	36	6,3	25	402	48	119	56	2,161	
TRL-MRd36-592	36	6,3	25	592	48	119	56	2,892	

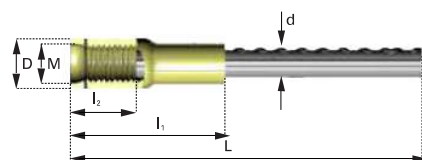

Lifting sockets

Boccola chiodo		Anchor socket							
Zincata elettrol.	Filetto	Carico	d	L	D	l ₁	l ₂	Peso	
Electrolytic Galv.	Threaded	Load Group	mm	mm	mm	mm	mm	Weight	
	Rd	f _{cu} >15N/mm ² t	mm	mm	mm	mm	mm	Kg/pz	
HBS-MRd12-70	12	1,3	10	70	17	45	25	0,083	
HBS-MRd12-130	12	1,3	10	130	17	45	25	0,120	
HBS-MRd16-090	16	2,5	14	90	22	58	30	0,194	
HBS-MRd16-140	16	2,5	14	140	22	58	30	0,254	
HBS-MRd16-200	16	2,5	14	200	22	58	30	0,327	
HBS-MRd20-125	20	4,0	18	125	27	74	37,5	0,401	
HBS-MRd20-258	20	4,0	18	258	27	74	37,5	0,667	
HBS-MRd24-140	24	5,0	20	140	32	87	45,5	0,581	
HBS-MRd24-325	24	5,0	20	325	32	87	45,5	1,038	
HBS-MRd30-185	30	7,5	24	185	39	101	56	1,044	
HBS-MRd30-400	30	7,5	24	400	39	101	56	1,807	
HBS-MRd36-475	36	10,0	28	475	47	131	66,5	3,054	
HBS-MRd42-550	42	12,5	34	550	54	153	78	4,976	
HBS-MRd52-575	52	15,0	34	575	68	189	97,5	6,335	

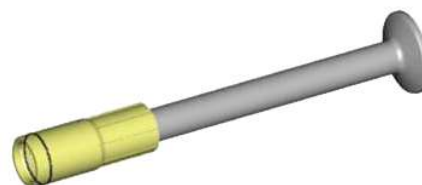
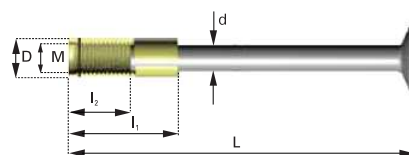

Tutti i tipi di boccole sono disponibili a richiesta con passo metrico M

All the sockets are available upon request with metric pacing

		Boccola bullone		Bolt anchor socket				Vite	Peso
Zincata a caldo	Filetto	Carico sollevamento	Carico di fissaggio		L	I	D	Screw	Weight
H.D.G. Hot Galvanized	Threaded	Lifting load	Fixing load		mm	mm	mm	M	Kg/pz
	M	t	B25 t	B45 t					
HBB M12-90-TV	12	0,75	1,8	2,6	90	23	16	12x60	0,103
HBB M12-100-TV	12	0,75	1,8	2,6	100	23	16	12x70	0,112
HBB M12-150-TV	12	0,75	1,8	2,6	150	23	16	12x120	0,156
HBB M16-140-TV	16	1,5	2,7	4,6	140	30	22	16x100	0,280
HBB M16-220-TV	16	1,5	2,7	4,6	220	30	22	16x180	0,406
HBB M20-140-TV	20	2,0	3,7	5,0	140	38	26	20x90	0,431
HBB M20-150-TV	20	2,0	3,7	5,0	150	38	26	20x100	0,456
HBB M20-180-TV	20	2,0	3,7	5,0	180	38	26	20x130	0,530
HBB M20-270-TV	20	2,0	3,7	5,0	270	38	26	20x220	0,752
HBB M24-200-TV	24	3,0	5,8	7,8	200	45	32	24x140	0,881
HBB M24-320-TV	24	3,0	6,0	10,9	320	45	32	24x260	1,307
HBB M30-240-TV	30	5,0	7,6	10,2	240	60	40	30x160	1,655
HBB M30-380-TV	30	5,0	10,2	18,3	380	60	40	30x300	2,432
HBB M36-300-TV	36	7,0	10,6	14,3	300	78	47,5	36x200	2,881
HBB M36-420-TV	36	7,0	14,5	24,5	420	78	47,5	36x320	3,839
HBB M42-300-TV	42	10,0	10,5	14,0	300	64	54	42x210	4,184
HBB M42-460-TV	42	10,0	20,5	28,0	460	64	54	42x270	5,934

Vite a testa esagonale
zincata elettrolitica classe 8.8

Hexagonal headed bolt electrolytic
galvanized - class 8.8

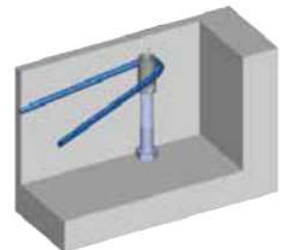
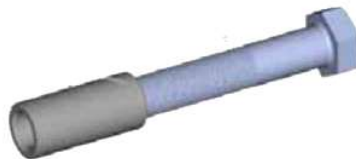
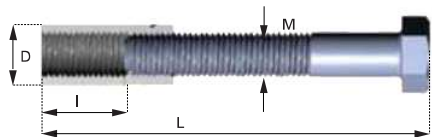

Tappo per Boccole		Plastic nailing for socket			
Codice	Filetto	S	D	d	Peso
Code	Threaded	mm	mm	mm	Weight
	M				Kg/pz
KU-10-M12-BR	12	10	55	45	0,018
KU-10-M16-BR	16	10	55	45	0,019
KU-10-M18-BR	18	10	55	45	0,020
KU-10-M20-BR	20	10	55	45	0,020
KU-10-M24-BR	24	10	55	45	0,024
KU-10-M30-BR	30	10	70	60	0,034

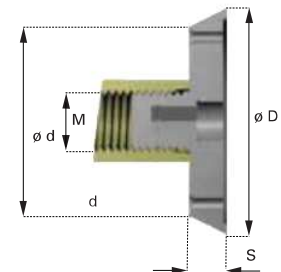
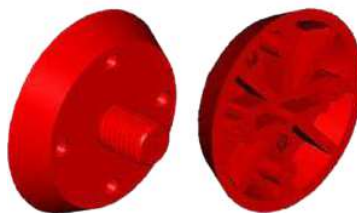

Asole flessibili per boccole BT-MAN Flexible slot for sockets						
Nera	Filetto	Carico	e	l	H	Peso
Black	Threaded	Load Group	mm	mm	mm	Weight
	Rd	kN	mm	mm	mm	Kg/pz
BT-MAN-12	12	9	22	32	155	0,08
BT-MAN-16	16	17	27	40	155	0,17
BT-MAN-20	20	32	35	50	215	0,33
BT-MAN-24	24	39	44	60	255	0,57
BT-MAN-30	30	50	55	85	300	1,29
BT-MAN-36	36	79	68	90	340	1,91
BT-MAN-42	42	102	75	100	425	2,69
BT-MAN-52	52	175	95	110	550	5,03

Tutti i tipi di boccole sono disponibili a richiesta con passo metrico M

All the sockets are available upon request with metric pacing

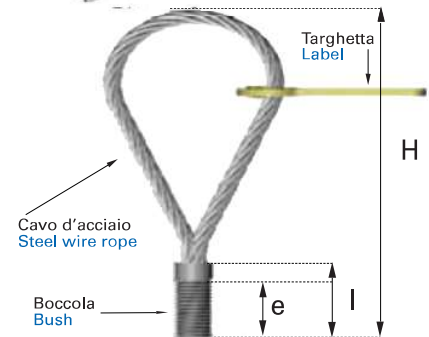
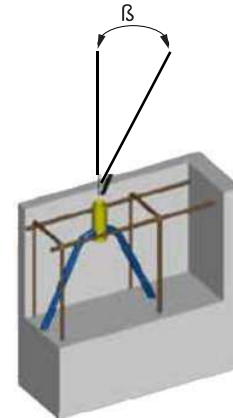

Cappio flessibile Loop							
Nero	Carico	Cavo d'acciaio	Dimensioni			L	Peso
Black	Load Group	Wire rope	Dimentions				Weight
	$f_{cu} > 15 \text{N/mm}^2$	diam mm	lung mm	f mm	e mm	mm	Kg/pz
	t						
BT-TIL-008	0,8	6	540	60	150	210	0,12
BT-TIL-012	1,2	7	570	65	160	225	0,16
BT-TIL-016	1,6	8	615	70	165	235	0,22
BT-TIL-020	2,0	9	690	75	200	275	0,32
BT-TIL-025	2,5	10	780	85	230	315	0,44
BT-TIL-040	4,0	12	860	100	240	340	0,69
BT-TIL-052	5,2	14	1010	100	260	360	0,99
BT-TIL-063	6,3	16	1100	110	280	390	1,41
BT-TIL-080	8,0	18	1250	120	320	440	2,08
BT-TIL-010	10,0	20	1350	135	390	525	3,01
BT-TIL-125	12,5	22	1500	150	420	570	3,90
BT-TIL-160	16,0	26	1650	165	450	615	6,05
BT-TIL-200	20,0	28	1900	180	550	730	8,00
BT-TIL-250	25,0	32	2000	200	600	800	11,28
BT-TIL-320	32,0	36	2225	220	550	770	13,40
BT-TIL-370	37,0	36	2500	275	675	950	15,90
BT-TIL-470	47,0	44	3000	320	780	1100	28,20
BT-TIL-520	52,0	44	3350	350	850	1200	31,05

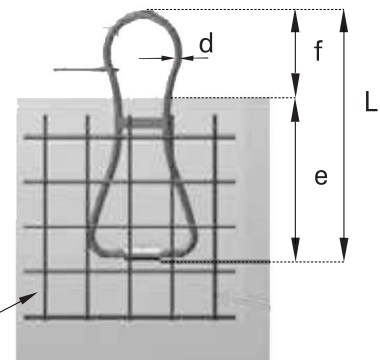
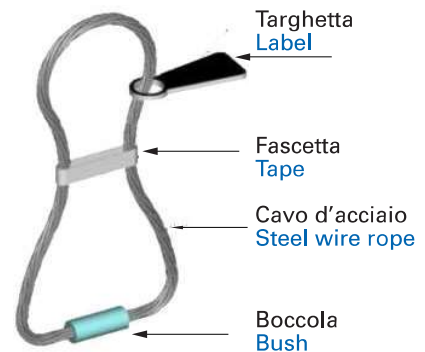

Armatura a carico dell'utilizzatore
Fabric or cage reinforcement